



Accessories for Ex 355 AZ Angled actuator AZ 335/355-B5 Material no.: 1170538 (material no. old: 01.08.0158)

Product features

- Especially suitable for hinged guards
- Actuating radius on hinged guards $a = 900$ mm and $b = 700$ mm
- Axial misalignment $x = 16$ mm

Dimensions

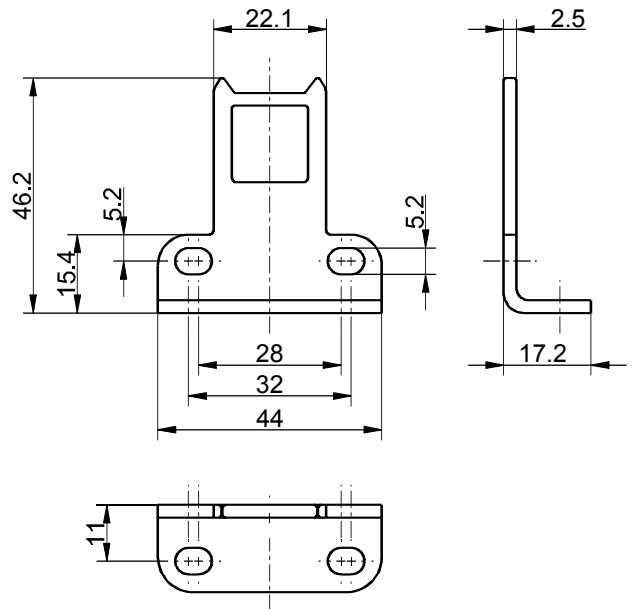

Actuating radii

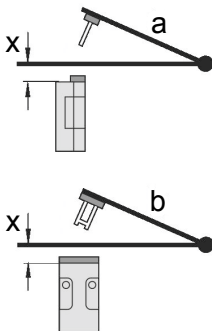

The axis of the hinge should be x mm above the top edge of the safety switch and in the same plane.

a = Actuating radius to the plane of the actuator

b = Actuating radius in line with the plane of the actuator

x = Axial misalignment

Attention! x must be referred to the surface of the enclosure and not to the inserted actuator!

Errors and omissions excepted.